

Alon Town Centre

Mixed-Use Development in North San Antonio

NW Military Hwy and Wurzbach Parkway



10003 NW Military Hwy, Suite #2205
San Antonio, TX 78231

t 210.593.0777
f 210.593.0780

www.fulcrumsa.com

fulcrum
DEVELOPMENT

Alon Town Centre

Mixed-Use Development in North San Antonio

Location:

SWC of Wurzbach Pkwy &
NW Military Hwy | San Antonio, TX

Second Floor Retail/Office:

- 2,054 SF

Rates:

Contact Broker

Property Description:

Alon Town Centre is a 330,000 square foot mixed-use retail and office development in the heart of the affluent North Side of San Antonio, Texas. Alon Town Centre is anchored by HEB's Alon Market, one of their most unique grocery concepts. The development includes a collection of distinctive shops, restaurants, and cafes in an urban retail village setting.



| Demographics | 1 mile | 3 mile | 5 mile |
|---------------|----------|----------|----------|
| Population | 12,371 | 108,722 | 271,012 |
| Households | 5,487 | 47,494 | 116,418 |
| Avg HH Income | \$90,150 | \$81,759 | \$75,320 |

Current Tenants:



10003 NW Military Hwy, Suite #2205
San Antonio, TX 78231

t 210.593.0777
f 210.593.0780

www.fulcrumsa.com

fulcrum
DEVELOPMENT



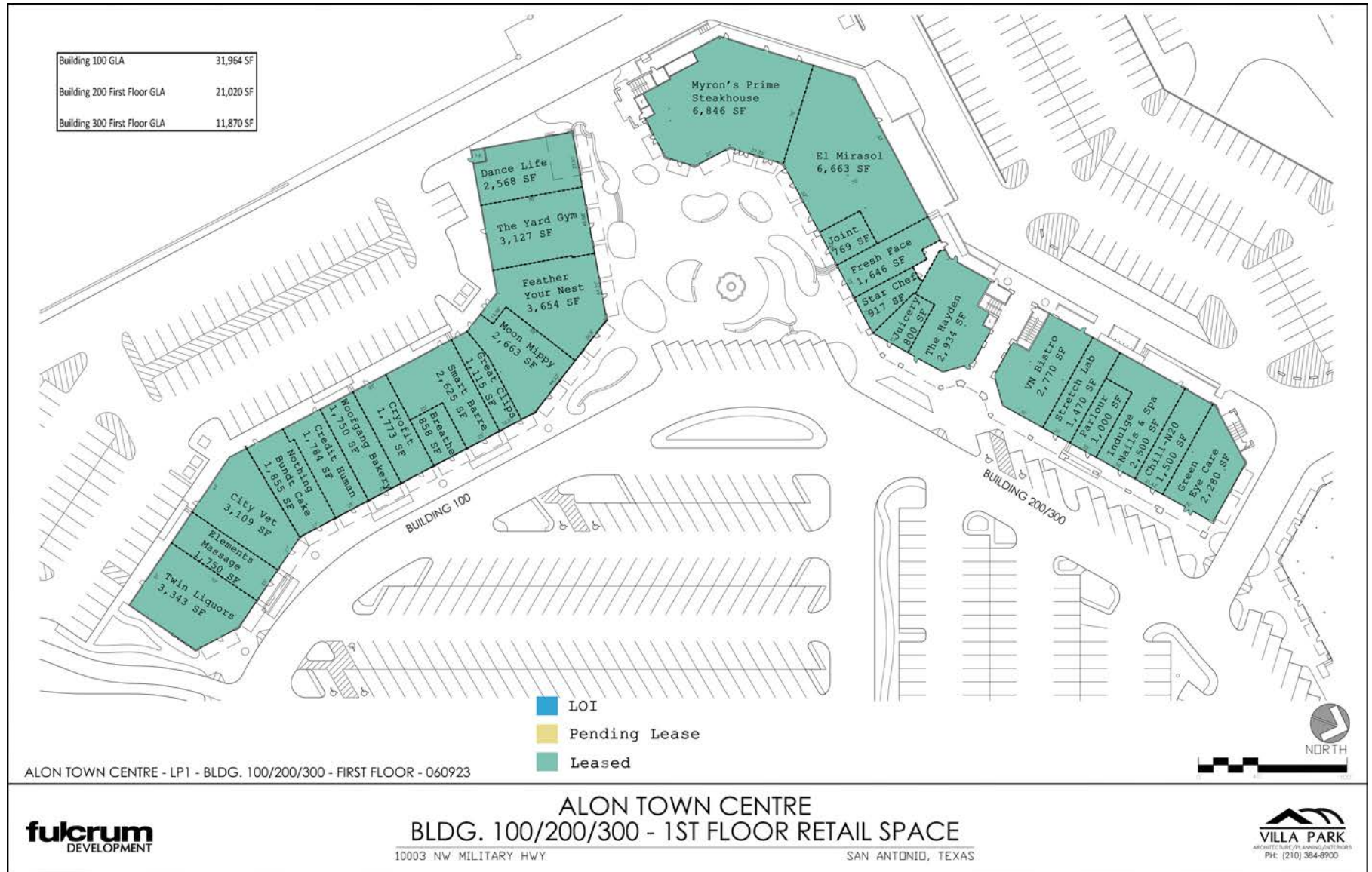

NOTE: THIS CONCEPTUAL SITE PLAN IS FOR MARKETING PURPOSES ONLY, & HAS BEEN PREPARED FOR CLIENT BASED UPON PRELIMINARY AVAILABLE SITE INFORMATION DEEMED RELIABLE. ALL DIMENSIONS, GRADES & AREA CALCULATIONS ARE SUBJECT TO VERIFICATION & MODIFICATION BY A PROFESSIONAL CIVIL ENGINEER FOR COMPLIANCE WITH ALL NATIONAL, STATE, & LOCAL REGULATIONS. NOT FOR REGULATORY APPROVAL, PERMITTING, OR CONSTRUCTION.

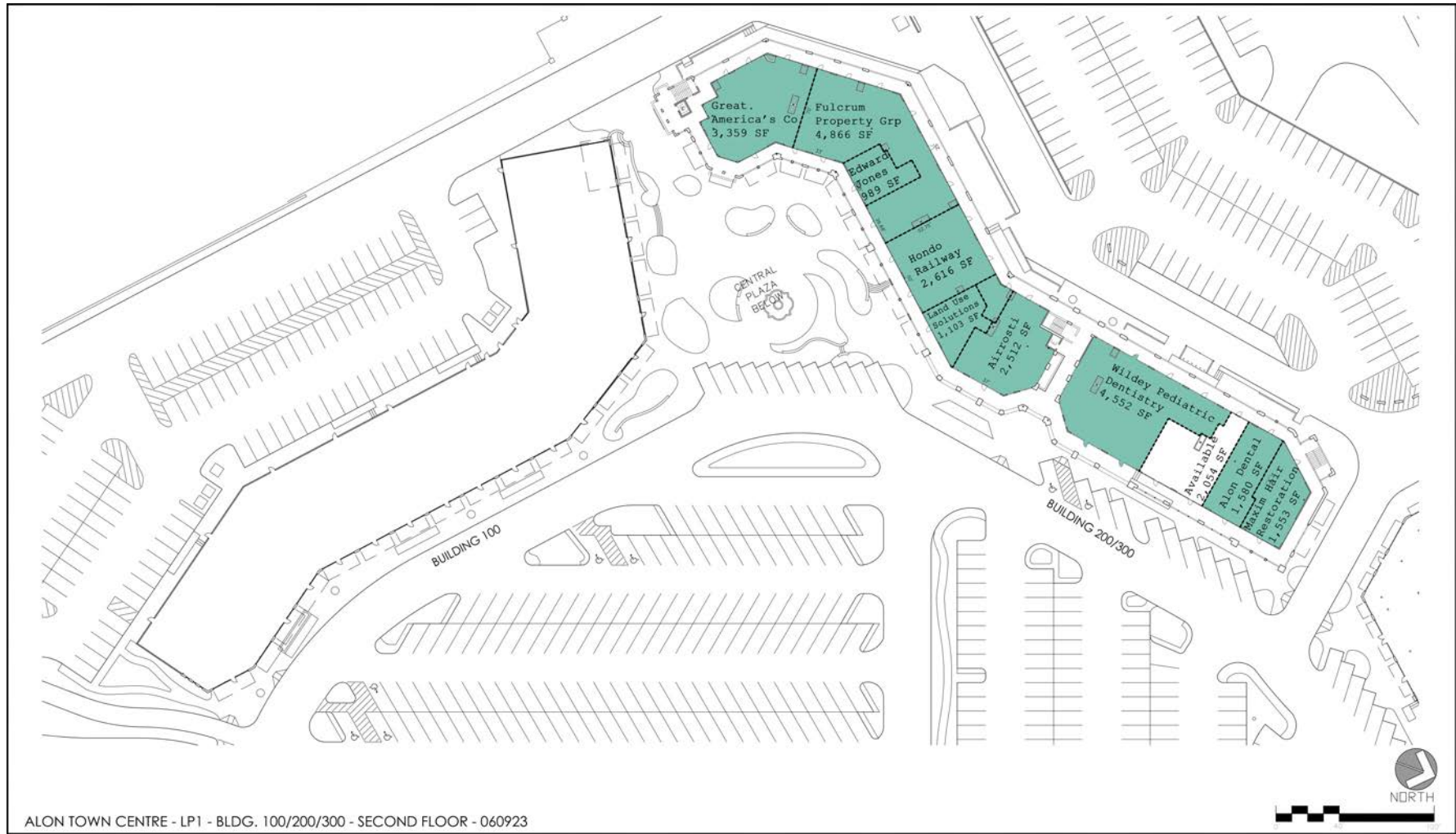

ALON TOWN CENTRE - LP1 - BLDG. 100/200/300 - SECOND FLOOR - 060923



ALON TOWN CENTRE
BLDG. 100/200/300 - 2ND FLOOR RETAIL SPACE

10003 NW MILITARY HWY

SAN ANTONIO, TEXAS



NOTE: THIS CONCEPTUAL SITE PLAN IS FOR MARKETING PURPOSES ONLY, & HAS BEEN PREPARED FOR CLIENT BASED UPON PRELIMINARY AVAILABLE SITE INFORMATION DEEMED RELIABLE. ALL DIMENSIONS, GRADES & AREA CALCULATIONS ARE SUBJECT TO VERIFICATION & MODIFICATION BY A PROFESSIONAL CIVIL ENGINEER FOR COMPLIANCE WITH ALL NATIONAL, STATE, & LOCAL REGULATIONS. NOT FOR REGULATORY APPROVAL, PERMITTING, OR CONSTRUCTION.

10003 NW Military Hwy, Suite #2205
San Antonio, TX 78231

t 210.593.0777
f 210.593.0780

www.fulcrumsa.com



Alon Town Centre

Shopping Center Pictures



10003 NW Military Hwy, Suite #2205
San Antonio, TX 78231

t 210.593.0777
f 210.593.0780

www.fulcrumsa.com

fulcrum
DEVELOPMENT

