

Bulverde Marketplace

Mixed-Use Development in North San Antonio

Bulverde Road and North Loop 1604



10003 NW Military Hwy, Suite #2205
San Antonio, TX 78231

t 210.593.0777
f 210.593.0780

www.fulcrumsa.com

fulcrum
DEVELOPMENT

Bulverde Marketplace

Traffic Counts & Demographics

Project Highlights:

- 400,000 SF of retail, restaurant and office space
- 330 urban style apartments
- Q1 - 2018 delivery date
- New major thoroughfare with three signaled intersections and one mile of road frontage
- Pedestrian oriented development located on the new Bulverde Rd. parkway
- Internal private street with traffic circle and cross walks
- Extensive common areas, walkways and landscape
- State of the art grocery store (H.E.B. Grocery Co.)

Availability:

- Street retail and restaurant space
- Inline retail & restaurant space 1,200-7,500 SF
- Anchor and Junior Anchor space
- Pad development

Traffic Counts:

- 92,500 VPD - Loop 1604
- 33,900 VPD - Bulverde Road



Demographics	1 mile	3 mile	5 mile
Population	6,859	88,642	189,681
Households	2,569	32,749	71,048
Avg HH Income	\$102,139	\$86,567	\$85,275

10003 NW Military Hwy, Suite #2205
San Antonio, TX 78231

t 210.593.0777
f 210.593.0780

www.fulcrumsa.com

fulcrum
DEVELOPMENT

Bulverde Marketplace

Aerial of Northeast San Antonio

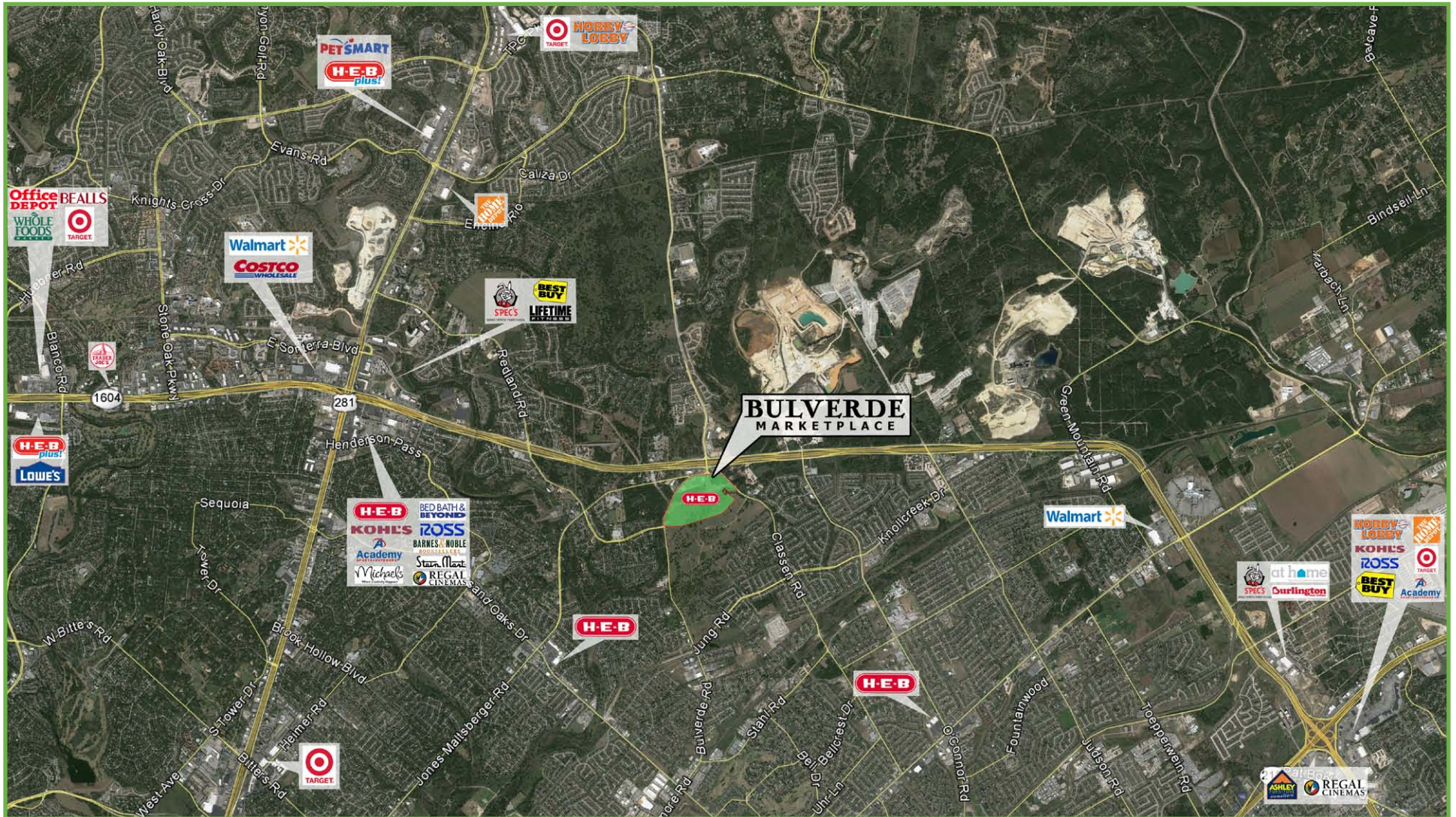

10003 NW Military Hwy, Suite #2205
San Antonio, TX 78231

t 210.593.0777
f 210.593.0780

www.fulcrumsa.com

fulcrum
DEVELOPMENT



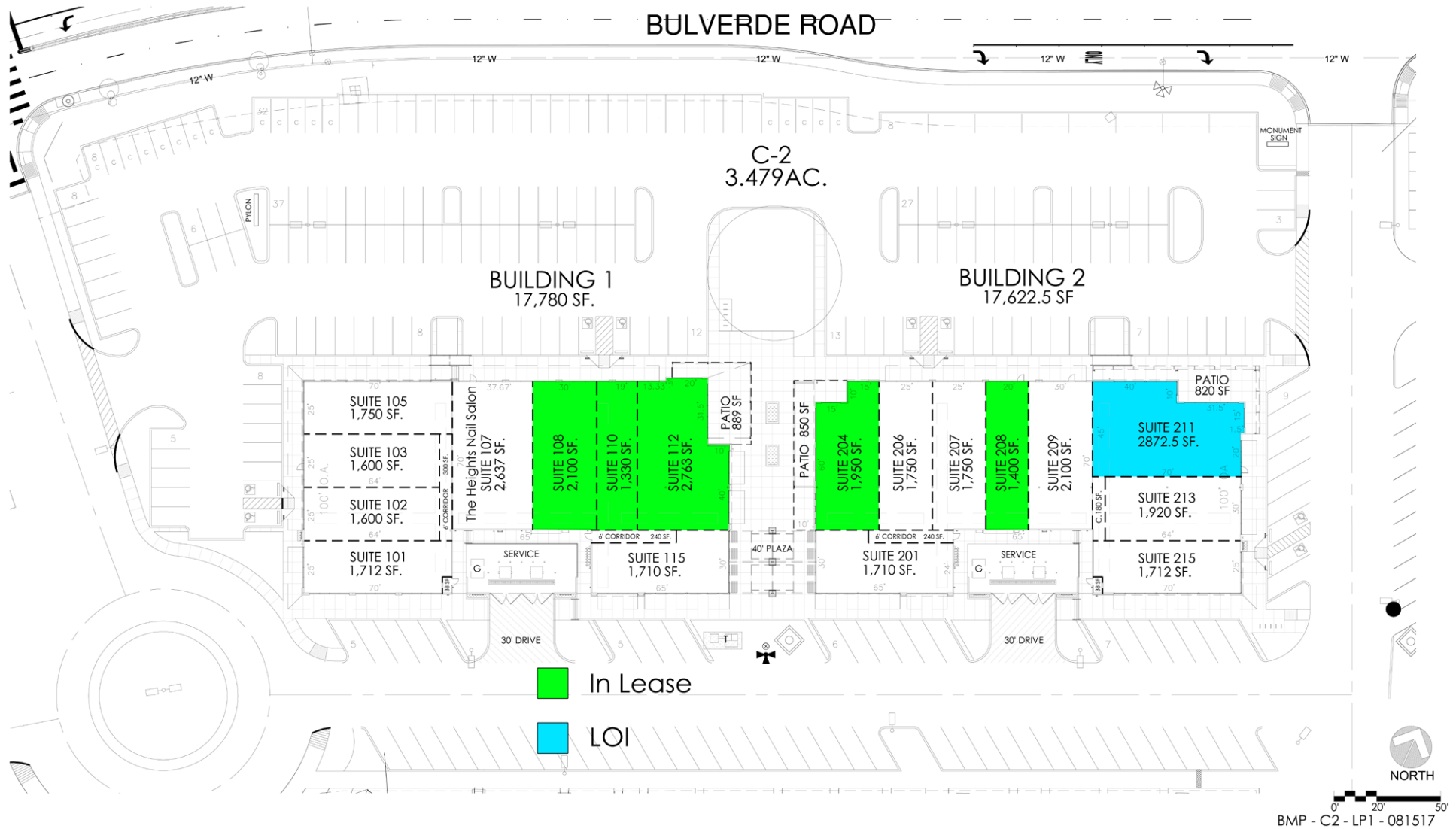

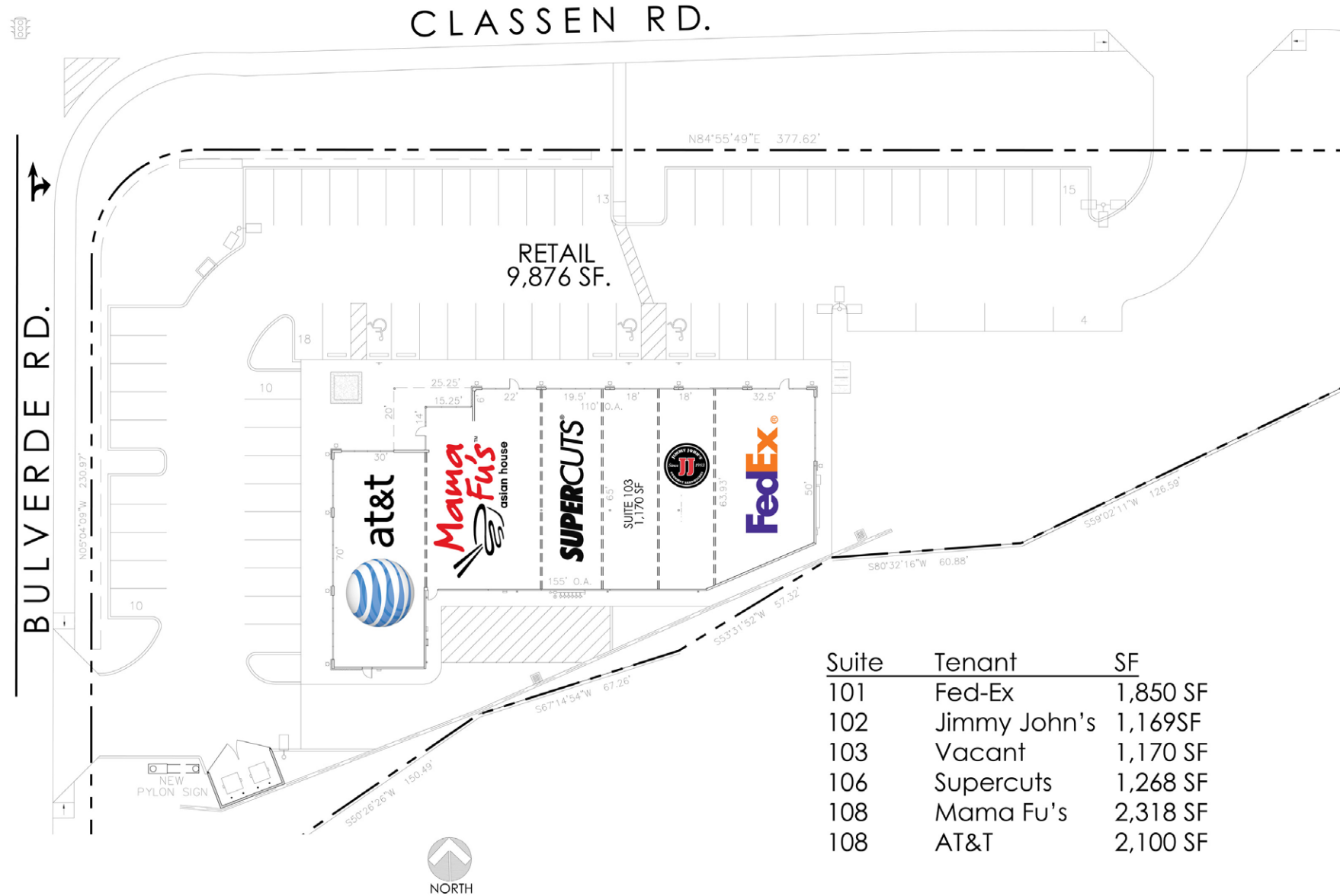

Suite	Tenant	SF
101	Fed-Ex	1,850 SF
102	Jimmy John's	1,169SF
103	Vacant	1,170 SF
106	Supercuts	1,268 SF
108	Mama Fu's	2,318 SF
108	AT&T	2,100 SF

Bulverde Marketplace

Bulverde Marketplace Site Plan

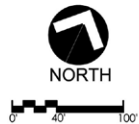
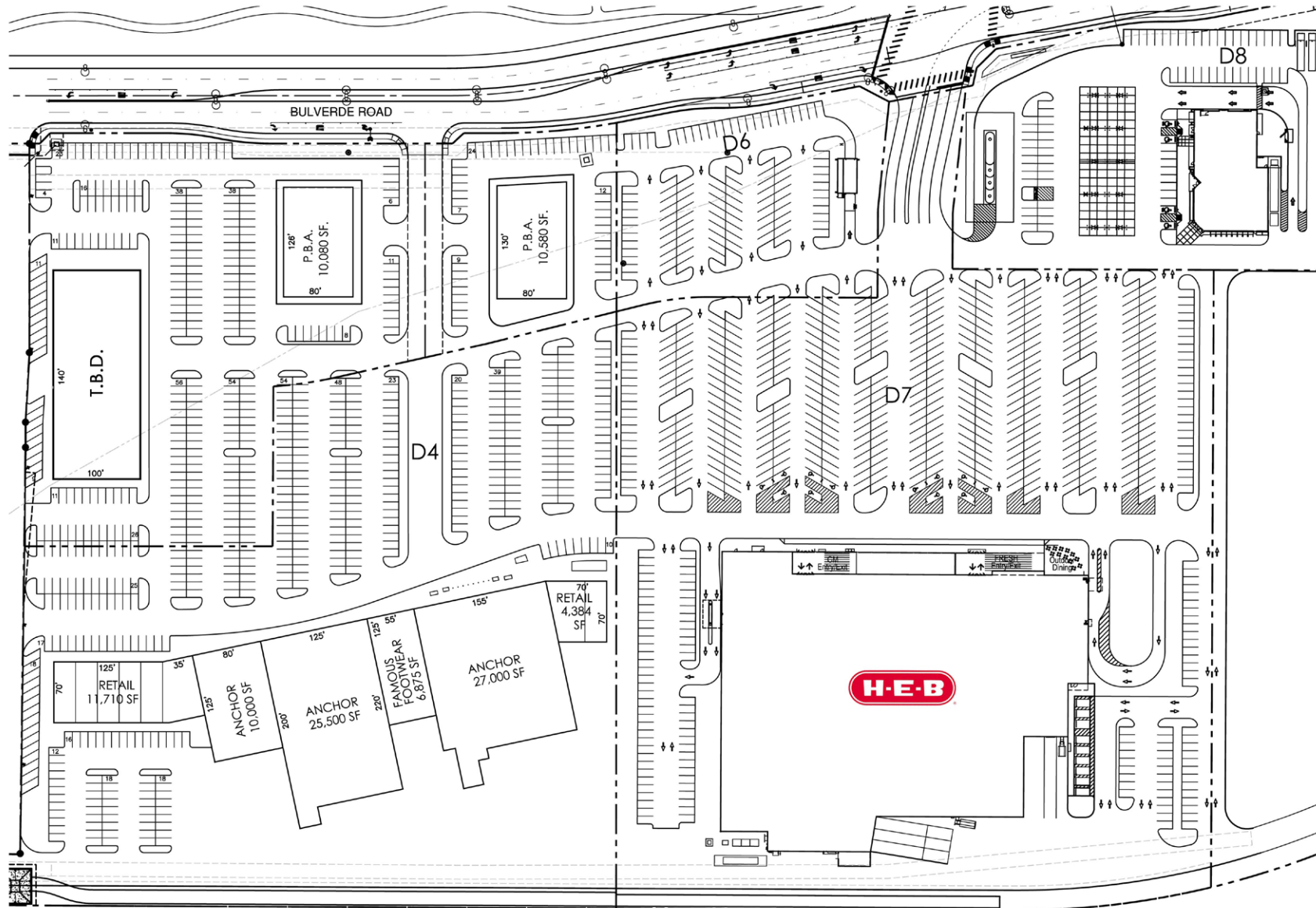

BMP III - SP1 - 103116

10003 NW Military Hwy, Suite #2205
San Antonio, TX 78231

t 210.593.0777
f 210.593.0780

www.fulcrumsa.com

fulcrum
DEVELOPMENT

Bulverde Marketplace

Bulverde North Building 1 Site Plan

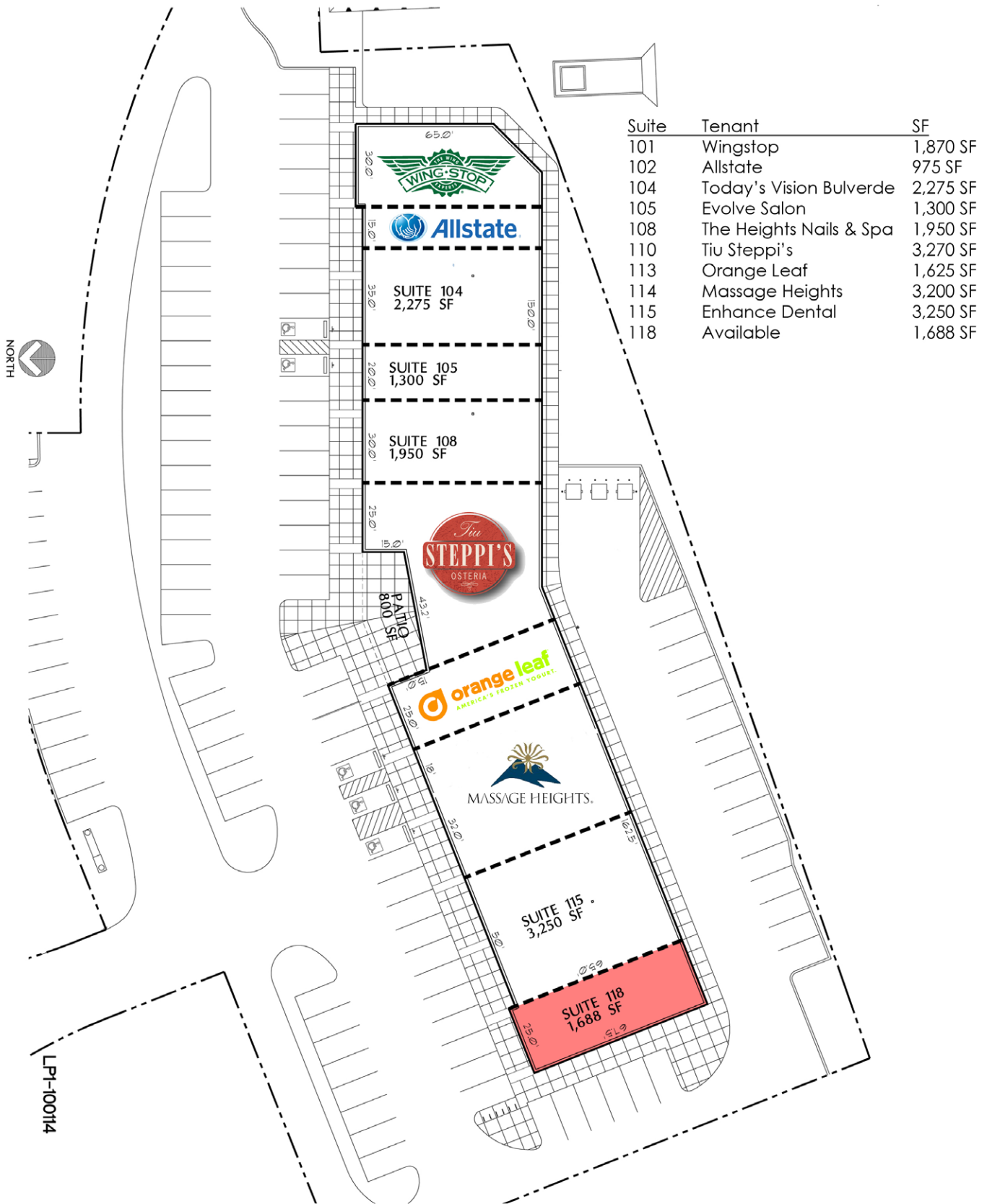

10003 NW Military Hwy, Suite #2205 t 210.593.0777

San Antonio, TX 78231

f 210.593.0780

www.fulcrumsa.com

fulcrum
DEVELOPMENT