

Tract 7 Preliminary Tabulations:

Lower Level:

Retail/Rest: ±32,075 sf

Corridors: ± 3,253 sf

Subtotal: ±35,328 sf

Upper Level:

Office: ±30,782 sf

Gross Area: ±66,110 sf

Parking Required (CoSA Min.):

Restaurant 16,000 sf @ 1/100 = 160 spaces

Retail 16,075 sf @ 1/300 = 54 spaces

Office 30,782 sf @ 1/300 = 103 spaces

Total Parking Required: 317 spaces (CoSA Min.)

Total Parking Provided: 280 spaces

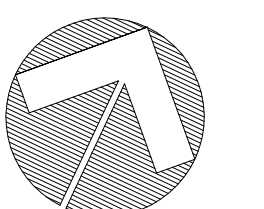

NORTH

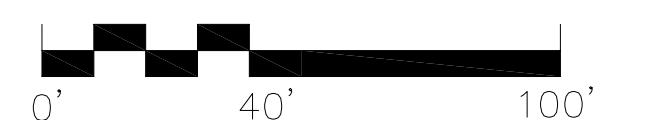

LANDMARK WEST - Lower Level - SP1 - 110518

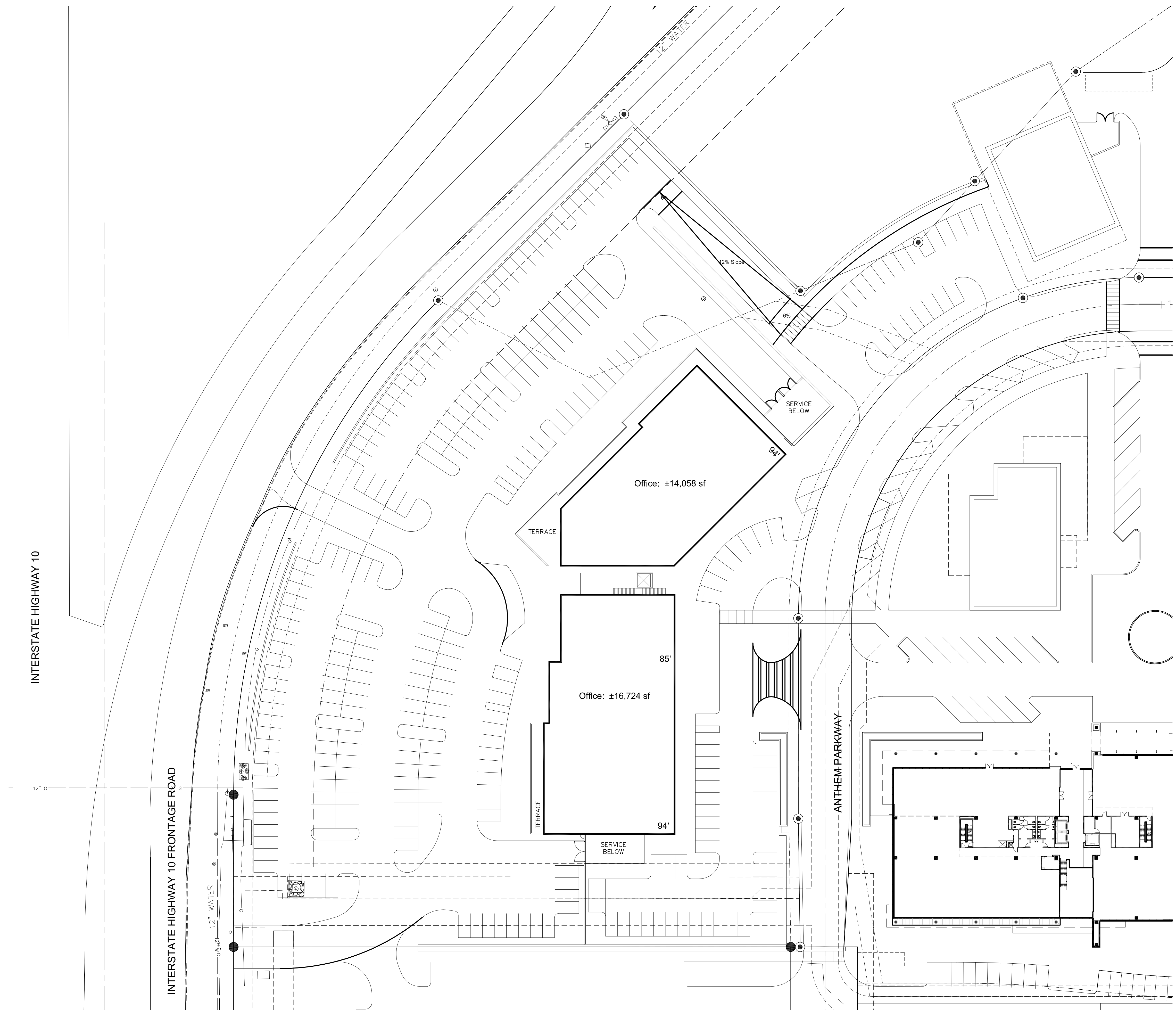

Tract 7 Preliminary Tabulations:

Lower Level:
 Retail/Rest: ±32,075 sf
 Corridors: ± 3,253 sf
 Subtotal: ±35,328 sf
 Upper Level:
 Office: ±30,782 sf

Gross Area: ±66,110 sf

Parking Required (CoSA Min.):
 Restaurant 16,000 sf @ 1/100 = 160 spaces
 Retail 16,075 sf @ 1/300 = 54 spaces
 Office 30,782 sf @ 1/300 = 103 spaces

Total Parking Required: 317 spaces (CoSA Min.)
 Total Parking Provided: 280 spaces

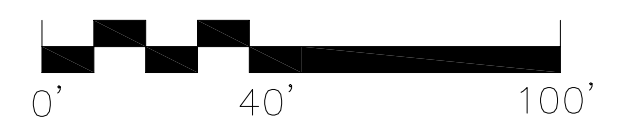

LANDMARK WEST - Upper Level - SP1 - 110518