

Alon Town Centre

Mixed-Use Development in North San Antonio

NW Military Hwy and Wurzbach Parkway



10003 NW Military Hwy, Suite #2205
San Antonio, TX 78231

t 210.593.0777
f 210.593.0780

www.fulcrumsa.com

fulcrum
DEVELOPMENT

Alon Town Centre

Mixed-Use Development in North San Antonio

Location:

SWC of Wurzbach Pkwy &
NW Military Hwy | San Antonio, TX

Retail Space Available:

- 858 - 3,654 SF

Office Space Available:

- 858 - 6,147 SF

Rates:

Contact Broker

Property Description:

Alon Town Centre is a 330,000 square foot mixed use retail and office development in the heart of the affluent North Side of San Antonio, Texas. Alon Town Centre is anchored by HEB Alon Market, one of HEB's most unique grocery concepts. The development includes a collection of distinctive shops, restaurants, and cafes in an urban retail village setting.



| Demographics | 1 mile | 3 mile | 5 mile |
|---------------|----------|----------|----------|
| Population | 12,371 | 108,722 | 271,012 |
| Households | 5,487 | 47,494 | 116,418 |
| Avg HH Income | \$90,150 | \$81,759 | \$75,320 |

Current Tenants:



10003 NW Military Hwy, Suite #2205
San Antonio, TX 78231

t 210.593.0777
f 210.593.0780

www.fulcrumsa.com

fulcrum
DEVELOPMENT

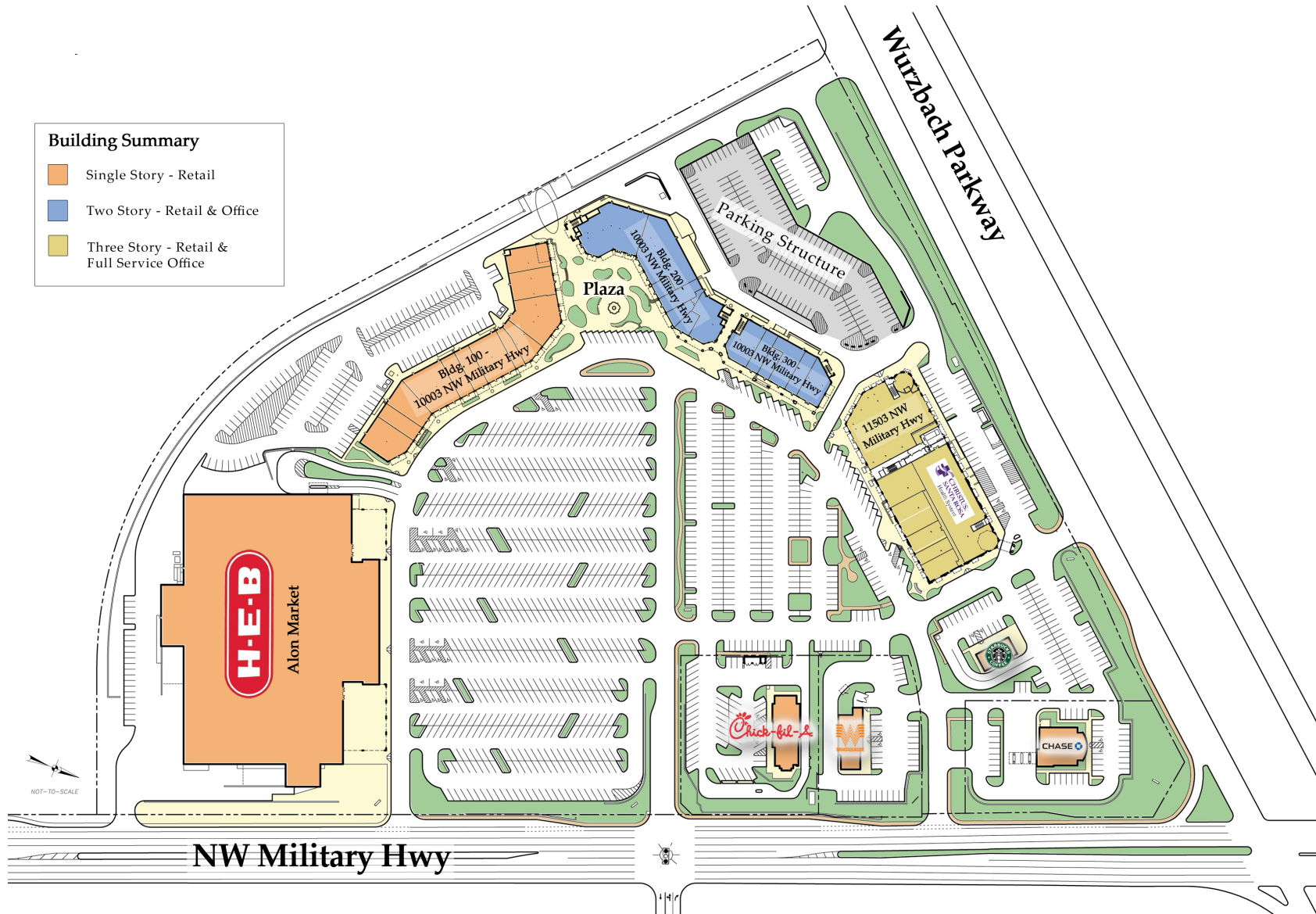

Alon Town Centre

1st Floor Retail Space



Alon Town Centre
1st Floor Leasing Plan

| | |
|------------------------------|-----------|
| Building 100 GLA | 31,964 SF |
| Building 200 First Floor GLA | 21,020 SF |
| Building 300 First Floor GLA | 11,870 SF |
| Occupied Space | |
| Available Space | |
| Elevator | |

10003 NW Military Hwy, Suite #2205
San Antonio, TX 78231

t 210.593.0777
f 210.593.0780

www.fulcrumsa.com



Alon Town Centre

2nd Floor Office Space

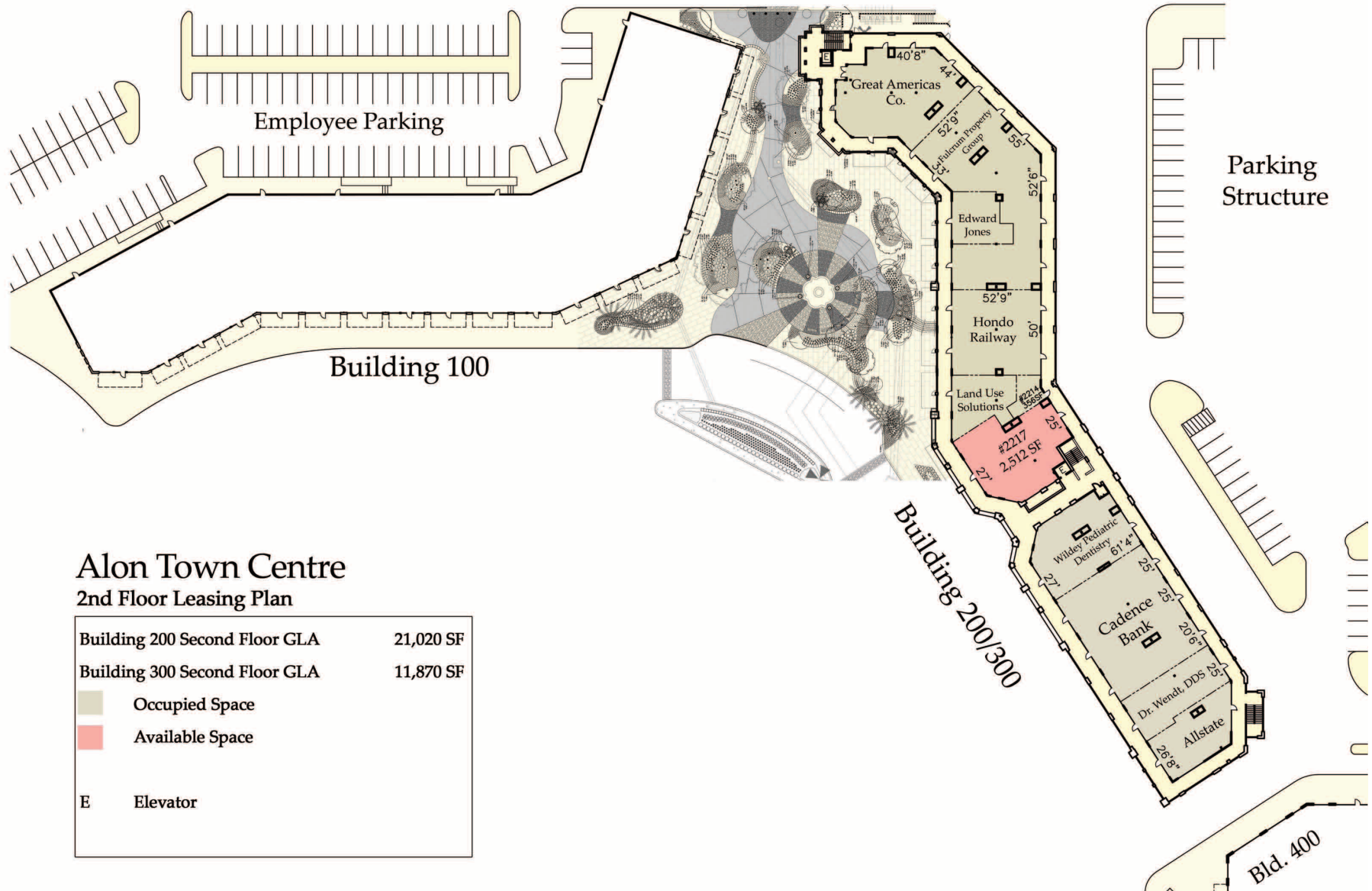

Alon Town Centre

Three Story Office Building

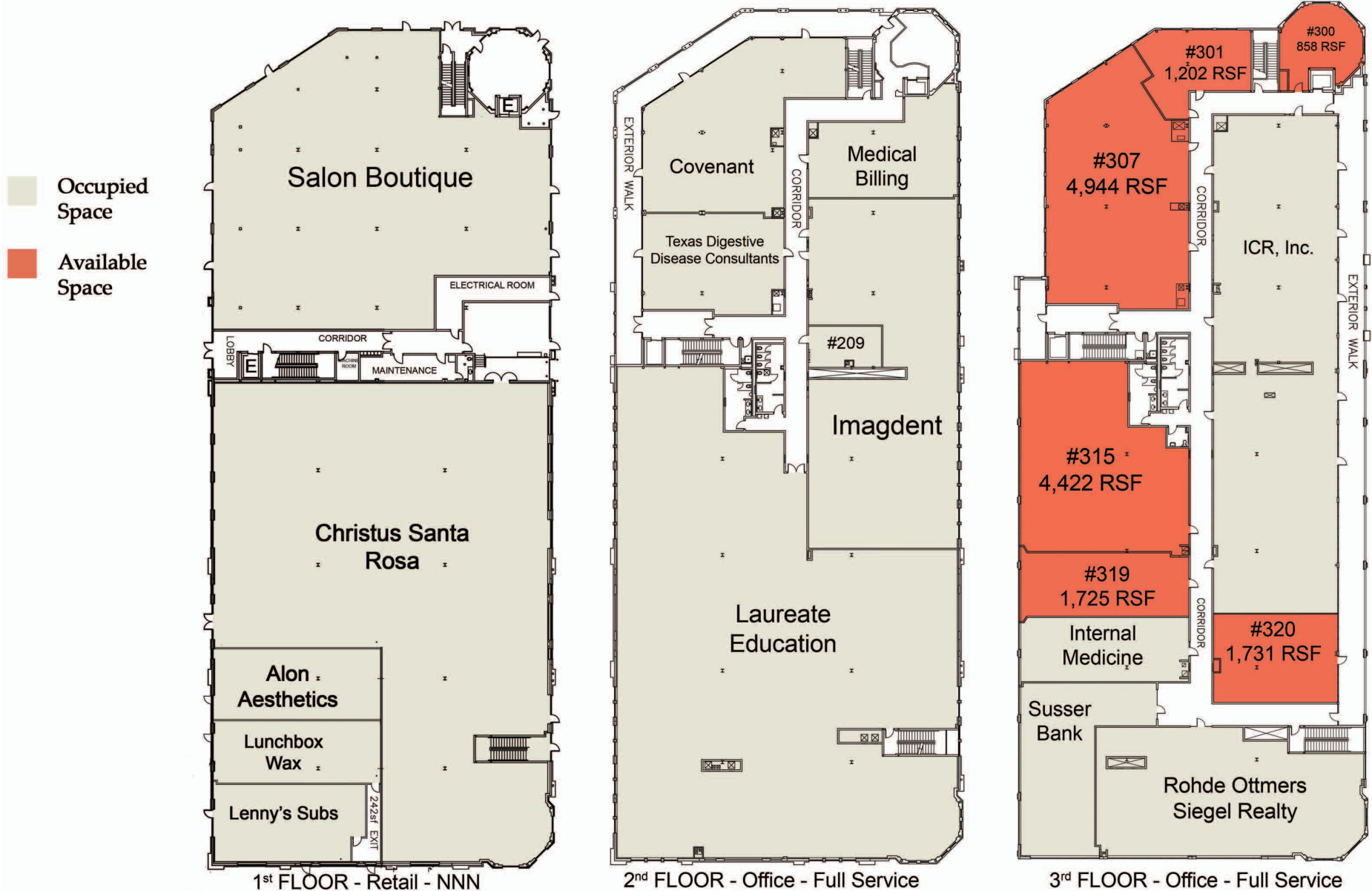

10003 NW Military Hwy, Suite #2205
 San Antonio, TX 78231

t 210.593.0777
 f 210.593.0780

www.fulcrumsa.com

fulcrum
 DEVELOPMENT

Alon Town Centre

Shopping Center Pictures



10003 NW Military Hwy, Suite #2205
San Antonio, TX 78231

t 210.593.0777
f 210.593.0780

www.fulcrumsa.com

fulcrum
DEVELOPMENT

